





Whitley Road, Hoddesdon, EN11 0PT

Westwood Leber are delighted to bring to the market this well-presented two-bedroom semi-detached family home, ideally located on the popular Whitley Road in Hoddesdon, EN11 0PT.

The property offers well-balanced and thoughtfully arranged accommodation, beginning with a welcoming entrance leading into a bright and spacious lounge, centred around a charming feature fireplace, creating a warm and inviting setting for everyday living. To the rear is a separate dining room, ideal for family meals and entertaining, which flows seamlessly through to a fitted kitchen offering ample worktop and storage space. The ground floor is further enhanced by a modern bathroom, completing the practical and versatile layout.

To the first floor, the home boasts two generously sized bedrooms, both offering excellent natural light and flexible space suitable for families, professionals, or home working.

Externally, the property benefits from a private rear garden providing an excellent space for outdoor seating, entertaining, and relaxation. A particularly attractive feature is the private gated access at the rear of the garden, which leads directly to convenient off-street parking located to the rear of the property. To the front, the home enjoys an attractive frontage and strong kerb appeal.

Whitley Road is superbly positioned within easy reach of Hoddesdon town centre, a variety of local shops, schools, and amenities, along with excellent transport links including Broxbourne Station, providing fast and direct services into London Liverpool Street. This appealing home would suit first-time buyers, investors, and downsizers alike, and an early viewing is highly recommended.



 WESTWOODLEBER

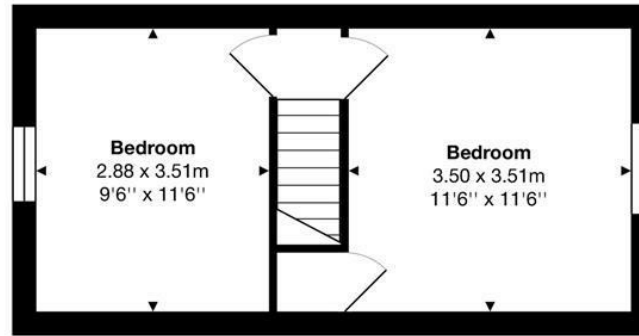

First Floor

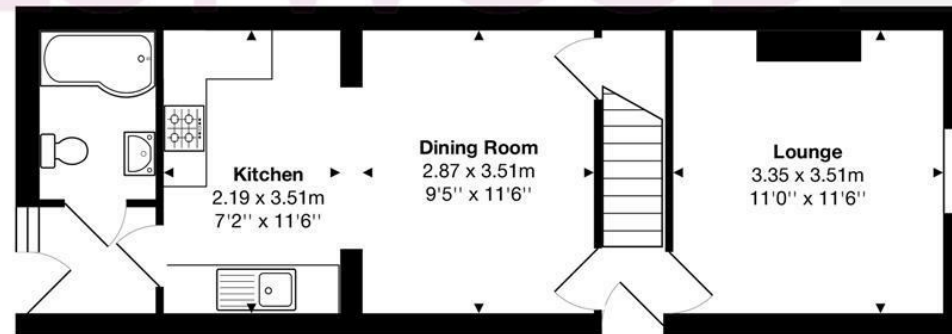

Ground Floor

Total Area: approx. 65.1 m² ... 701 ft²

THE FLOORPLAN IS FOR ILLUSTRATIVE PURPOSES ONLY AND IS NOT TO SCALE.
Measurements and features are approximate and may differ from the actual property. Verify all details independently; no liability is accepted for errors or omissions.

Property marketing provided by www.fotomarketing.co.uk



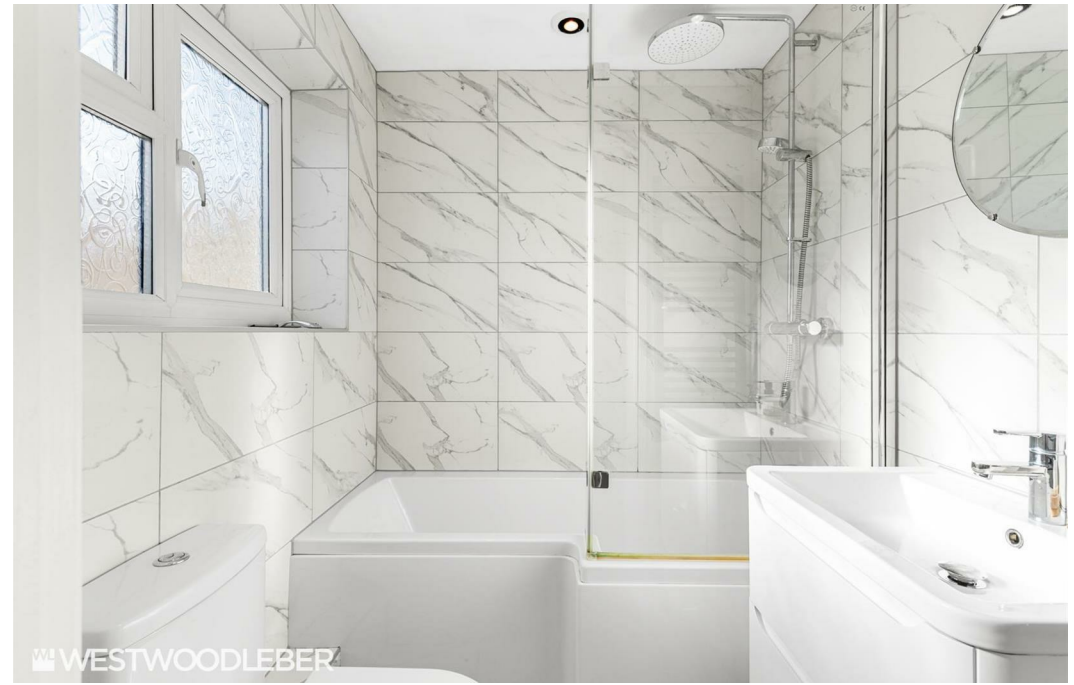









WESTWOODLEBER